

DESCRIPTION



Two way normally closed lift assisted piston solenoid valve with spring return.

Suitable for gaseous and liquid media compatible with the (body/seals) material used. Vacuum.

Suitable for zero differential pressure applications.

Forged brass, nickel-plated brass or stainless steel body (1/2" & 3/4" only).

Stainless steel guide tube, springs and internal parts.

Solenoid can be rotated 360°.

Valve will operate in any position, preferably with vertical coil upwards.

DIMENSIONS mm

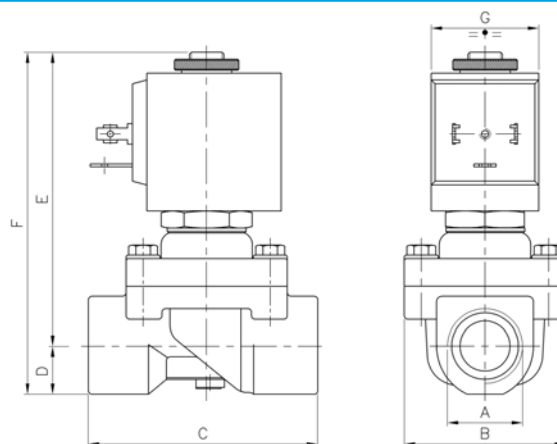

Port size	Dimensions in millimeters (mm)							
A	B	C	D	E	F	G		
3/8"	45	64	14	82	96	C3	C4	
1/2"	45	64	14	82	96	30	36	
3/4"	54	82	17	88	105	30	36	
1"	72.5	100	20	95	115	36	36	

ELETTICAL INFORMATION

Continuous duty glass-reinforced nylon moulded coil with electrical connection suitable for DIN-43650 plug (2 poles+ground) or faston wire terminal . Two cables available on request.

Coil type:	C3 / C4		
Insulation class:	F (155°C), H (180°C) on request.		
Winding wire class:	H (180°C)		
Protection class:	Waterproof IP-65 (norme EN60529) when properly plug connetted when DIN-43650 plug.		
Duty:	Continuous (S.I.) 100% ED		
Power consumption:	C3	Alternate Current	13VA (inrush 20VA)
		Direct Current	8W
	C4	Alternate Current	22VA (inrush 40VA)
		Direct Current	27W
Voltage tollerance:	a.c. +10% ÷ -15%, d.c. +10% ÷ -5%		
Electrical Insulation:	>500 MOhm		
Dielectrical Strenght:	>2000 V/1'		
Standard voltage:	d.c. 12, 24 Volt		
	a.c. 24, 110, 230 Volt (50/60 Hz)		
	other voltages available on request.		

OPERATION

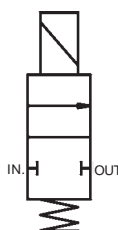

Normally close

In : IN
Out : OUT
Coil de-energised : IN and OUT close.
Coil energised : IN to OUT

SPECIFICATIONS AND AVAILABLE OPTIONS

MODEL						ORIFICE mm	PRESSURE IN BAR						Flow factor kv (l/min.)	WEIGHT Kg.	
							NOMINAL MAX.	MIN./MAX. DIFFERENTIAL PRESSURE				with coil C3		with coil C4	
								MIN.	MAX. with coil C3		MAX. with coil C4				
a	b	c	d	e	f			AC~	DC=	AC~	DC=				
	L 04	D/N	13			12,7	16	0	10	-	14	12	35	0,592	0,674
	L 04	E/O	13			12,7	16	0	10	-	14	12	40	0,562	0,644
	L 04	F/Q	19			19	16	0	8	-	10	8	90	0,858	0,94
	L 04	G/R	25			25	16	0	-	-	7	4	176	1,40	1,482

a Construction	b Valve type	c Port size	d Seals material	e Body material	f Optional feature
A AC C DC	L 2 way N.C.	D 3/8" GAS N 3/8" NPT E 1/2" GAS O 1/2" NPT F 3/4" GAS Q 3/4" NPT G 1" GAS R 1" NPT <div></div> <i>NPT port available only on request</i>	B NBR V VITON E EPDM W EPM WT PX * T PTFE <i>* KTW certified for food</i>	T Brass N Nickel-plated brass I Stainless steel * <i>* available only for 1/2" and 3/4" valves.</i>	SG Clean for oxigene